

Harlequin Liberty Sprung Panel Floor System

Permanent installation guide



A. Preparation

Before commencing installation, sweep or vacuum the subfloor thoroughly to remove any loose grit or dirt.

Panels should always be handled or carried by two people. Take care not to damage panel corners and edges when handling and always set panels down onto the groove side first and then lay flat.

Before commencing, look carefully at your room and at the installation diagram. Position the first panel so that the edges with the latches and the edges with the receivers are in accordance with your installation drawing.



A WORD ON SAFETY

- Use tools in accordance with the manufacturer's instructions.
- Use gloves, safety goggles and masks as appropriate.
- Work in a well-ventilated space when using adhesives and wear protective footwear.
- For comfort, you might want to wear knee-pads.
- When cutting panels, work standing using a workbench or trestle.

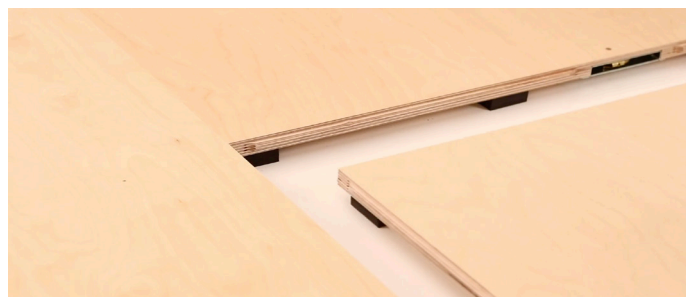

B. Installation

Lay the first row of panels along the length of the room, leaving an expansion gap of 10mm between the edge of the panels and the wall, but DO NOT latch the panels together at this stage (panels A-D on diagram).

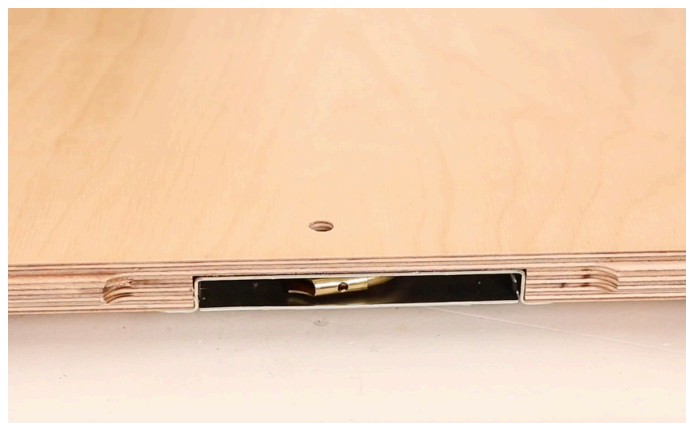
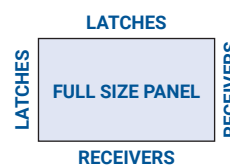
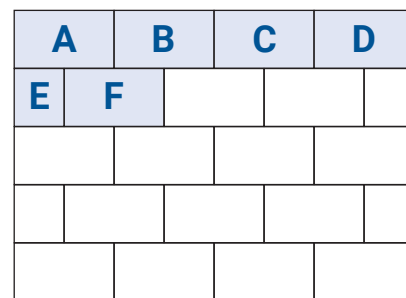

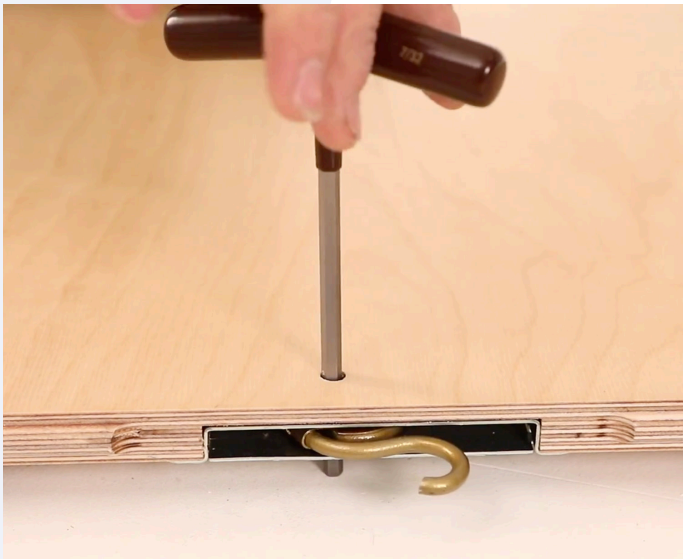
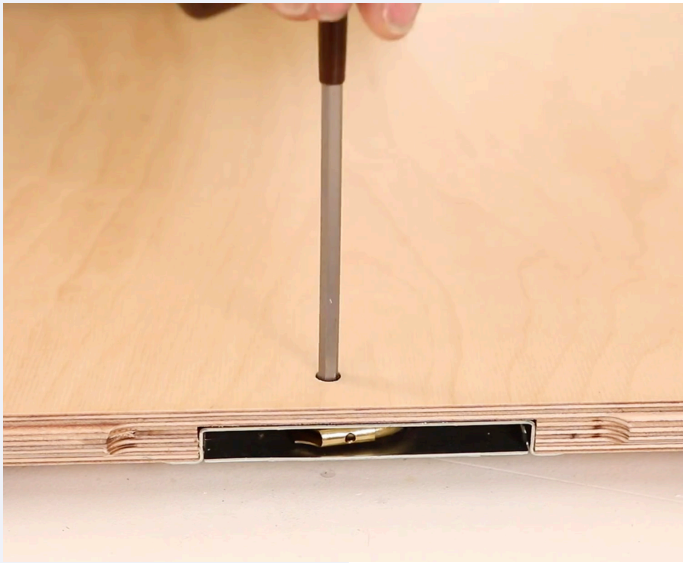

Lay the first panel of the second row (panel E) and latch it to the first panel of the first row (panel A), using the latching tool supplied. Ensure that each latch is fully retracted by turning the key first in an anti-clockwise direction until you hear a click, then turn it fully in a clockwise direction to engage it in the receiver. If panels are aligned correctly, the latches engage easily.

Lay the second panel of the second row (panel F), then latch E to F, followed by F to A, then A to B and F to B. Lay all the panels in the second row in the same way and continue laying one complete row after another until all the panels are laid.

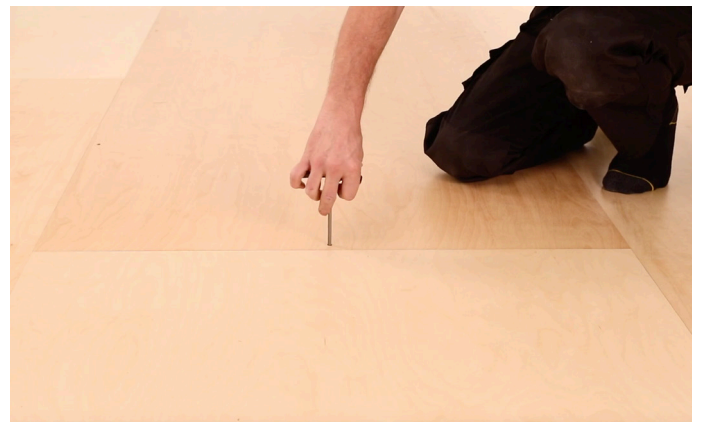

To fit around obstructions such as pillars, cut the panels to size allowing an expansion gap of 10mm and stick extra pads on the underside of the cut edges using double-sided tape before latching in place.

Finally, attach any ramps according to your installation diagram, latching them in place in the same way.

**PLEASE
NOTE**

If you had to remove any pads when cutting your panels and you have been left with a gap that is 60mm or more to the edge, please re-attach the pads using double-sided tape, so that you have full support to the edge of the panels before fitting them.

If you would like further information, advice and samples please contact us on +44(0) 1892 514 888 or enquiries@harlequinfloors.com



HARLEQUIN
www.harlequinfloors.com